

Wheel Accessories Catalogue

Table Of Contents

Acorn Lug Nut Covers	Page 1	Chrome Hub Caps & Adaptors	Page 4 To Page 7
Standard Lug Nut Covers	Page 1	Stainless Steel Hub Caps	Page 8
Bullet Lug Nut Covers	Page 2	Chrome Axle Covers	Page 8 To Page 10
Standard Lug Nut Covers With Flange	Page 2	Stainless Steel Wheel Covers	Page 9 to Page 10
Bullet Lug Nut Covers With Flange	Page 3	Stainless Steel Wheel Simulator Kits	Page 11
Flat Top Lug Nut Covers With Flange	Page 3	Stainless Steel Wheel Inserts	Page 12
Alcoa Lug Nut Covers With Flange	Page 4		
Bullet Lug Nut Covers Blister Pack	Page 5		
Lug Nut Puller	Page 5		

Our Location

Truck Bits
14-20 Knowles Rd
Dandenong South, 3175
Victoria, Australia
Ph : (03) 9702 8788
Fax :(03) 9702 8045

ACORN LUG NUT COVERS.



Part No :	Size :	Height :	Shape :	Flange :	Material :
NC3/8	3/8"	5/8"	ACORN	NO	ZINC DIE CAST
NC7/16	7/16"	5/8"	ACORN	NO	ZINC DIE CAST
NC1/2	1/2"	11/16"	ACORN	NO	ZINC DIE CAST
NC9/16	9/16"	11/16"	ACORN	NO	ZINC DIE CAST
NC5/8	5/8"	3/4"	ACORN	NO	ZINC DIE CAST
NC11/16	11/16"	13/16"	ACORN	NO	ZINC DIE CAST
NC3/4	3/4"	15/16"	ACORN	NO	ZINC DIE CAST
NC7/8	7/8"	1-1/8"	ACORN	NO	ZINC DIE CAST

STANDARD LUG NUT COVERS.



Part No :	Size :	Height :	Shape :	Flange :	Material :
NC15/16	15/16"		STANDARD	NO	STEEL
204-3	1"	1-1/4"	STANDARD	NO	STEEL
8004	1-1/16"	1-1/8"	STANDARD	NO	STEEL
8015	1-1/8"	1-1/4"	STANDARD	NO	STEEL
8029	1-3/16"		STANDARD	NO	STEEL
8002	1-1/4"		STANDARD	NO	STEEL
NC41	41mm	2"	STANDARD	NO	STEEL
NC41SS	41mm		STANDARD	NO	STAINLESS STEEL

BULLET LUG NUT COVERS.



Part No :	Size :	Height :	Shape :	Flange :	Material :
1516P	1-5/16"		BULLET	NO	STEEL
8027	34.5mm	1-7/8"	BULLET	NO	STEEL
201	1-1/2"	2"	STANDARD	NO	STEEL
202	1-1/2"		STANDARD		

STANDARD LUG NUT COVERS WITH FLANGE.



Part No :	Size :	Height :	Shape :	Flange :	Material :
NC118F	1-1/8"	1-5/8"	STANDARD	YES	STEEL
8023	1-1/4"	2"	STANDARD	YES	STEEL
204	1-1/2"		STANDARD	YES	STEEL
8024	41mm		STANDARD	YES	STEEL
8024I	41mm		STANDARD	YES	STEEL

BULLET LUG NUT COVERS WITH FLANGE.



Part No :	Size :	Height :	Shape :	Flange :	Material :
1516	1-5/16"		BULLET	YES	STEEL



NC33FPP	33mm		BULLET	YES	PLASTIC
---------	------	--	--------	-----	---------

FLAT TOP LUG NUT COVERS WITH FLANGE.

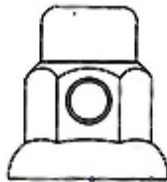

Part No :	Size :	Height :	Shape :	Flange :	Material :
NC31F	31mm		FLAT TOP	YES	STEEL
0003	32mm		FLAT TOP	YES	STEEL
0004	33mm		FLAT TOP	YES	STEEL

ALCOA LUG NUT COVERS WITH FLANGE.



Part No :	Size :	Height :	Shape :	Flange :	Material :
185100	threaded			YES	PLASTIC
182000	33mm			YES	PLASTIC

LUG NUT PULLER.



NCP Lug Nut Puller Adjustable

CHROME HUB CAPS & ADAPTORS.



1154	6" Chrome Hub Cap. (NEW).
7001252	6" Rear Chrome Hub Cap. Suits Fruehauf Plastic Axle Cap. Can be used on Stemco Front Axle Cap.
1155	6-1/2" Chrome Hub Cap. (NEW).
1253	7-1/4" Front Chrome Plastic Hub Cap. * Screw-On Cap with Adaptor.
0007	7-1/4" Rear Chrome Hub Cap. Suits some Mack Applications. * Can be used on Stemco Front Axle with 9000C Clips.
1480	7-5/8" Rear Chrome Hub Cap. Suits some Volvo Applications.
1151	8" Rear Chrome Hub Cap. Suits some Rockwell Axles. * Can be used on Stemco Front Axle with 1451 Adaptor. * Can be used on Stemco Front Axle with 9001C Clips. (NEW).

CHROME HUB CAPS & ADAPTORS (CONT)

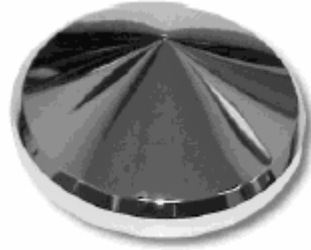

- 1151P 8" Rear Chrome Cone Shaped Hub Cap. Suits some Rockwell Axles. (NEW).
 * Can be used on Stemco Front Axle with 1451 Adaptor.
 * Can be used on Stemco Front Axle with 9001C Clips. (NEW).



- 1151H 8" Rear Chrome Hub Cap with 4-3/4" Hole for Hubodometer.

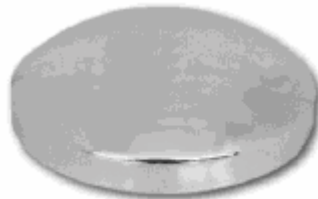

- 9104 8-1/2" Rear Chrome Hub Cap. Suits some Mack Applications.
 0009 8-1/8" Rear Chrome Hub Cap. Suits some Rockwell Axles.
 0008 8-1/4" Rear Chrome Hub Cap.



- 8002-06 8-5/8" Front Chrome Hub Cap. Suits Alloy Wheels.
 *4 Cut-Outs - 4 Clips.



- 1491P 8-5/8" Front Chrome Cone Shaped Hub Cap. Suits Alloy Wheels. (NEW).
 *4 Cut-Outs - 4 Clips.

CHROME HUB CAPS & ADAPTORS (CONT)



- 1491H 8-5/8" Front Chrome Hub Cap with 4-3/4" Hole for Hubodometer.
* 4 Cut-Outs - 4 Clips.



- HB10 9-1/4" Rear Moon Style Chrome Hub Cap. Suits some Volvo Application.
* Use with 7001080 5/8" I.D. Clips.

- HUB335 11" Front Chrome Hub Cap. Suits 335mm P.C.D. Wh
• 5 Cut-Outs – 5 Clips.



- 7001080 Clip Spring Steel for use with HB10 Rear Hub Cap.
* Suits 5/8" Axle Stud.



- 7001452 Adaptor Plate for Stemco Front Axle Cap. (Multi-Drilled) Use 8" Hub Cap.

CHROME HUB CAPS & ADAPTORS (CONT)

HUBA

Adaptor Plate for Stemco Front Axle Cap. Use 8" Hub Cap.

- 2 Required per Cap.

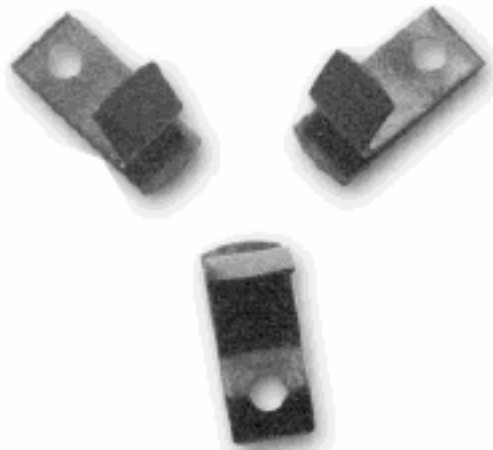

9000C

Clip Spring Steel for Stemco Front Axle Cap. Use 7-1/4" Hub Cap.

* 3 Required per Cap.

10583

Clip Spring Steel for Stemco Front Axle Cap. Use 8" Hub Cap. (NEW).

* 3 Required per Cap. (comes in pack of 3)

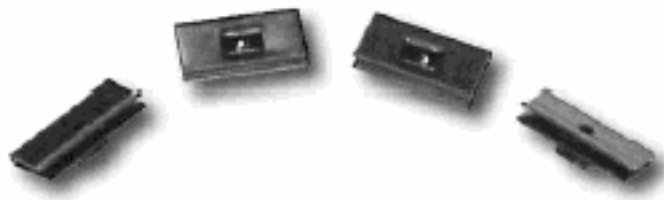

10511

Clip Set to Suit Alcoa Front Hub Caps.

* 4 Required per Cap.



STAINLESS STEEL HUB CAPS.

- 1298SS 7-1/4" Rear Stainless Steel Hub Cap. Suits some Mack Applications.
* Can be used on Stemco Front Axle Cap with 9000C Clips.
- 1151SS 8" Rear Stainless Steel Hub Cap. Suits some Rockwell Axles.
* Can be used on Stemco Front Axle with 1451 Adaptor.
* Can be used on Stemco Front Axle with 9001C Clips. (NEW).
- 1228SS 8-1/8" Rear Stainless Steel Hub Cap. Suits some Rockwell Axles.
- 1491SS 8-5/8" Front Stainless Steel Hub Cap. Suits Alloy Wheels.
* 4 Cut-Outs - 4 Clips.



CHROME AXLE COVERS.

- 1493 11-1/4" Front Chrome ABS Plastic Axle Cover with Nut Covers. (NEW).
* Nut Covers Screw Down on the Stud Threads and Interlock into Cover.
* Fits 10 Stud with 11-1/4" (285mm) P.C.D.
* Replacement Nut Cover NC-1493.



- 4019 8-1/2" Axle Cover *N.B. requires Beauty Ring
4019H 8-1/2" Front Chrome Axle Cover with 3-1/2" Inspection Hole.
* N.B. 2018 Beauty Ring is Required to Attach Axle Cover.
* Fits 10 Stud with 11-1/4" (285mm) P.C.D.

- 335 13-1/4" Front Stainless Steel Axle Cover.
* Fits 10 Stud with 13-1/4" (335mm) P.C.D.



2016 8-1/2" Rear Chrome Axle Cover (9" High). Top Hat Style
 * N.B. 2018 Beauty Ring is Required to Attach Cover.
 * Fits 10 Stud with 11-1/4" (285mm) P.C.D.

2017 8-1/2" Rear Chrome Axle Cover (9" High). Removable Hub Cap
 Top Hat Style
 * N.B. 2018 Beauty Ring is Required to Attach Cover.
 * Fits 10 Stud with 11-1/4" (285mm) P.C.D.

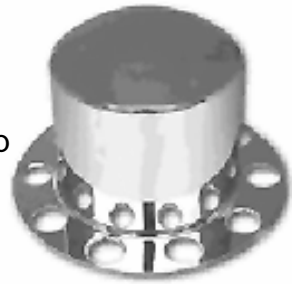

2018A 11-1/4" Chrome Beauty Ring 10 Hole.
 *Use with 4019H, 2016 and 2017 Covers.
 2015 Top Hat Suit 335 PCD
 RING2018 Beauty Rig Suit 335 PCD



STAINLESS STEEL WHEEL COVERS.



335-RING 16-1/2" Stainless Steel Front Wheel Ring. Open Centre. (NEW).
 * Used as Step on European Applications.
 * Fits 10 Stud with 13-1/4" (335mm) P.C.D.
 * HB10 Chrome Hub Cap can be Fitted to Centre with Silastic.



335-RINGC 16-1/2" Stainless Steel Front Wheel Ring. Covered Centre. (NEW).
 *Used as Step on European Applications.
 * Fits 10 Stud with 13-1/4" (335mm) P.C.D.

STAINLESS STEEL WHEEL COVERS (CONT).



- 195F 19.5" Stainless Steel Front Wheel Cover with Mounting Ring and Screws.
* Supplied with Anti-Theft Screws and Screwdriver.
- 195R 19.5" Stainless Steel Rear Wheel Cover with Mounting Ring and Screws.
* Supplied with Anti-Theft Screws and Screwdriver.



- 225F 22.5" Stainless Steel Front Wheel Cover with Mounting Ring and Screws.
* Supplied with Anti-Theft Screws and Screwdriver.
- 225R 22.5" Stainless Steel Rear Wheel Cover with Mounting Ring and Screws.
* Supplied with Anti-Theft Screws and Screwdriver.
- 225FSS 22.5" Stainless Steel Front Wheel Cover with Fixed Nut Covers, Mounting Ring and Screws.
* Supplied with Anti-Theft Screws and Screwdriver. (NEW).
- 225RSS 22.5" Stainless Steel Rear Wheel Cover with Fixed Nut Covers, Mounting Ring and Screws.
* Supplied with Anti-Theft Screws and Screwdriver. (NEW).
- 225RING 22.5" Mounting Ring to Suit 225F, 225R, 225FSS and 225RSS Wheel Covers.
- 225SCREW Stainless Steel Screw with Special Hex Head to Suit 175, 195 and 225 Wheel Covers.
- 225S/DRIVER Screwdriver with Special Hex Head to Suit 175, 195 and 225 Wheel Covers.
- 225 BLOCK Block to Suit Mounting Ring

STAINLESS STEEL WHEEL SIMULATOR KITS.



- 135007 15" x 5.5 Stainless Steel Wheel Simulator Kit. Suits 5 Stud Wheels.
* Kit Consists of 2 Front / Rear Covers with Nut Covers.
* 115mm Offset with 35mm Nut Covers.
* 8" P.C.D.
- 135008-1 16" x 5.5 Stainless Steel Wheel Simulator Kit. Suits 5 Stud Wheels.
* Kit Consists of 2 Front / Rear Covers with Nut Covers.
* 115mm Offset with 41mm Nut Covers.
* 8.25" P.C.D.
- 135008-2 16" x 5.5 Stainless Steel Wheel Simulator Kit. Suits 5 Stud Wheels.
* Kit Consists of 2 Front / Rear Covers with Nut Covers.
* 115mm Offset with 41mm Nut Covers.
* 8" P.C.D.
- 5508 16" Stainless Steel Wheel Simulator Kit. Suits 8 Stud Wheels.
* Suits Ford and Chevy Dual Wheels.
* Kits Consist of 2 Front / Rear Covers with Nut Covers.
- 15610 16" x 6 Stainless Steel Wheel Simulator Kit. Suits 6 Stud Wheels.
* Kit Consists of 2 Front / Rear Covers with Nut Covers.
* 127mm Offset with 41mm Nut Covers.
* 8.75" P.C.D.
- 15620 16" x 6 Stainless Steel Wheel Simulator Kit. Suits 6 Stud Wheels.
* Kit Consists of 2 Front / Rear Covers with Nut Covers.
* 135mm Offset with 41mm Nut Covers.
* 8.75" P.C.D.
- 15630 17.5" x 6 Stainless Steel Wheel Simulator Kit. Suits 6 Stud Wheels.
* Kit Consists of 2 Front / Rear Covers with Nut Covers.
* 135mm Offset with 41mm Nut Covers.
* 8.75" P.C.D.
- 15140 22.5" Stainless Steel Wheel Simulator Kit. Suits 10 Stud Wheels.
* Kit Consists of 2 Front / Rear Covers with Nut Covers.
* 165mm Offset with 38mm Nut Covers.

STAINLESS STEEL WHEEL INSERTS.



16SSR	16" Stainless Steel Insert to Suit all 16" Wheels.
SSR /ACCURIDE	22.5" Stainless Steel Inserts to Suit Accuride Wheels.
SSR	22.5" Stainless Steel Inserts to Suit Road King Spider Wheels.
SSR / DISC	22.5" Stainless Steel Inserts to Suit Disc Wheels.
42-1999	19.5" X 6" 8 *8 Lug *5 Hand Holes (Nut Covers Included)
42-1958	19.5" x 5 stud *5 Lug Front, 10 Lug Rear *5 Hand holes
42-1611	16" *8 Stud
5509	16" *8 Stud *Multi-fit *Snap On